

Essential GMP Skills: Facility Cleaning

Skills and Training Laboratories Training Course
Sycamore House
Cell and Gene Therapy Catapult

Essential GMP Skills

Facility Cleaning

This one-day classroom and laboratory course provides hands-on training for GMP production staff. It focuses on aseptic cleaning techniques, regulatory compliance, and safe manufacturing practices in pharmaceutical and biopharmaceutical facilities.

Learning objectives:

- Understanding GMP Principles by defining and explaining the importance of Good Manufacturing Practices (GMP) in facility cleaning and its impact on the final product.
- Identify and select appropriate cleaning agents, sanitizers, and equipment for different areas within a GMP facility and understand the proper use and maintenance of cleaning equipment.
- Define cleanroom classifications and their significance in pharmaceutical and biotech manufacturing and identify the specific cleaning requirements for different cleanroom classes.
- Develop cleaning procedures and protocols and follow standardized cleaning procedures for various facility areas to minimize the risk of contamination using a digital SOP.
- Understand the risks and potential sources of cross-contamination during cleaning activities and implement measures to prevent cross-contamination between different areas and equipment.
- Validation and Verification of Cleaning Processes. Discuss the principles of cleaning validation and verification whilst understanding the importance of documenting and maintaining cleaning records.
- Identify the appropriate use of personal protective equipment during cleaning operations and emphasize personal hygiene practices to prevent the introduction of contaminants.
- Comprehend proper procedures for waste disposal in accordance with GMP standards.
- Develop an understanding of emergency response procedures in case of spills or accidents during cleaning and know how to handle and report incidents related to cleaning activities.

Essential GMP Skills: Facility Cleaning

Course title	Essential GMP Skills: Facility Cleaning
Course level	Introductory
Course fee (per delegate)	£500 + VAT
Course dates	Available upon request
Venue	CGT Catapult Skills and Training Laboratories, Sycamore House, Stevenage

Who should attend

Individuals new to regulated industries—biotherapeutics, ATMPs or pharmaceuticals—and staff in Manufacturing, QC, QA, cleanrooms, validation, compliance, engineering, and maintenance seeking stronger understanding of GMP cleaning requirements.

Pre-course expectations and recommendations:

- It is beneficial if delegates have a basic understanding with facility cleaning and aseptic techniques.
- Delegates will benefit from a basic understanding of GMP and ATMP, for delegates without this understanding we recommend attendance on [An Introduction to Biomanufacturing and Advanced Therapies](#) and [Essential GMP Skills - GMP Overview and an Introduction to the world of GxP](#).
- If you are unsure if this course is suitable for you, please contact our Skills team via skillstraininglabs@ct.catapult.org.uk we will be happy to advise.
- Before starting this course, participants will be required to complete and sign the course-specific registration form.

Assessment

Delegates will be encouraged to participate in discussions and reflect on activities at all times. There will be a variety of surface cleaning technique assessment practical to complete. You will be asked to complete a post course questionnaire at the end of the course.

Agenda

Time	Essential GMP Skills: Facility Cleaning
9.00 - 10.00	<p>Welcome, Introductions & STL Induction</p> <p>Session 1: Overview of Good Manufacturing Practices (GMP)</p> <ul style="list-style-type: none"> - Definition and importance of GMP within Regulatory framework and guidelines. <p>Session 2: GMP Requirements for Facility Cleaning</p> <ul style="list-style-type: none"> - Detailed exploration of GMP guidelines related to facility cleanliness. - Discussion on regulatory standards and compliance in your facility.
10.00 - 11.15	<p>Session 3: Importance of Proper Cleaning in GMP Environment</p> <ul style="list-style-type: none"> - Real-life case studies illustrating the consequences of inadequate cleaning. - The impact of cleanliness on final product quality and risk mitigation. <p>Session 4: Cleanrooms and Controlled Environments</p> <ul style="list-style-type: none"> - Review of practical techniques for GMP facility cleaning.
11.15 - 11.30	BREAK
11.30 - 13.00	<p>Session 5: Cleaning Procedures and Protocols</p> <ul style="list-style-type: none"> - Step-by-step walkthrough of effective cleaning procedures. - Hands-on demonstration of proper cleaning techniques. <p>Session 6: Selection and Use of Cleaning Agents</p> <ul style="list-style-type: none"> - Understanding different types of cleaning agents and their applications. - Safety considerations and proper handling of cleaning chemicals, waste removal and spills. <p>Session 7: Cleaning Equipment and Tools</p> <ul style="list-style-type: none"> - Overview of tools and equipment used in GMP facility cleaning. - Practical demonstrations and practice sessions.
13.00 - 13.45	LUNCH
13.45 – 17.00 Including afternoon break	<p>Practical Applications – Designing and Implementing a GMP Cleaning Program</p> <p>Session 8: Developing a Site-Specific Cleaning Plan</p> <ul style="list-style-type: none"> - Tailoring cleaning plans to the specific needs of your facility using a digital SOP. - Group activity: Creating a sample cleaning plan. <p>Session 9: Quality Control and Monitoring</p> <ul style="list-style-type: none"> - Establishing metrics for cleanliness and quality control. - Incorporating routine inspections into the cleaning program. <p>Session 10: Documentation and Record Keeping</p> <ul style="list-style-type: none"> - Importance of accurate documentation in GMP environments. - Hands-on exercise: Creating standardized cleaning logs.
17.00 - 17.30	Day Review, feedback and closure

Address:

Sycamore
House
Leyden Road
Stevenage
SG1 2BP

How to find us

Driving – to park in our carpark use the vehicle security gate on Leyden Road

What3words ///slip.cakes.owners

By taxi or on foot - use the pedestrian security gate on Gunnells Wood Road

What3words ///parent.risk.lines

Once on site proceed to the main reception located on the south-west side of the building

No smoking

Please be aware that Stevenage Science Park is a no smoking site.

Contact us

We want you to enjoy this training course, but if you have any concerns, please do not hesitate to contact us at skillstraininglabs@ct.catapult.org.uk.

Sycamore House is located just outside Stevenage town centre.

Sycamore House is close to the A1(M) via junction 7, the connectivity of the campus by car is considered good. Stevenage is well connected to major hubs. Cambridge is only 40 kilometres away and reachable within 40 minutes by train, and it takes only a 21 - minute train journey to reach King's Cross in London. In addition, Luton and Stansted international airports are reachable within 40 minutes and Heathrow within 1 hour.

Parking

There are designated car parking spaces available to CGT Catapult staff and visitors to Sycamore House including one electric charging parking space. Car parking is available on a first-come, first-served basis. Our parking spots are marked with the Catapult logo/sign. There are additional parking spots for visitors that is shared among the other tenants in the building. These spots can be booked via building reception in advance.

Additional parking at Stevenage Football Club is available for nine cars for Catapult employees and visitors – see map below.

Directions

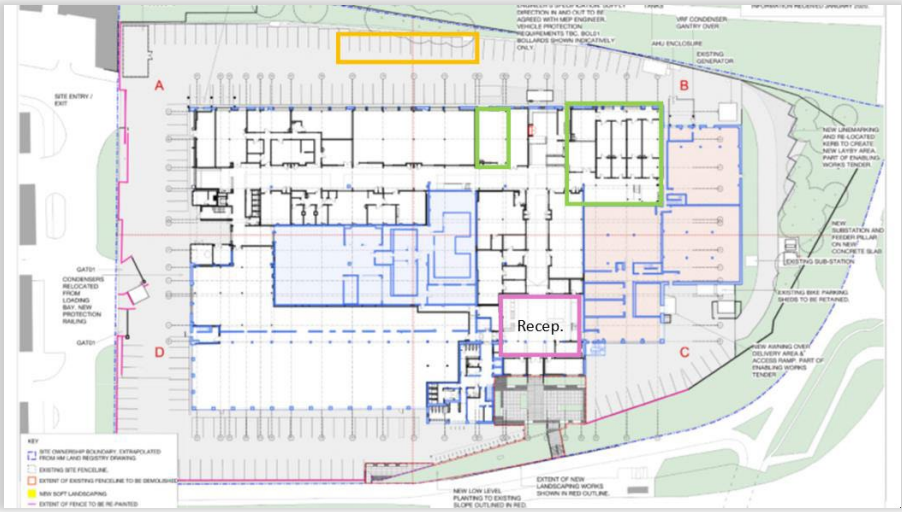

Area marked in orange is car parking allocated to CGT Catapult employees on a first-come, first-served basis.

The building entrance / reception is marked with purple, and the CGTC ground floor areas, including our Skills and Training Laboratories are marked in Green.

Walking and cycling

Although the walk from the town centre and station takes approximately 25 minutes, there are continuous footpaths and cycleways, and safe crossings all the way to our entrance.

There are 33 cycle spaces for general use. There is a bike store located at the front of the building entrance accessed via Gunnells Wood Road. The spaces for the bikes are available on a first-come, first-served basis.



Car Parking at Stevenage Football Ground

Map showing the additional parking available at the East and West areas of Stevenage football ground.

